

## Connect to Guest Wi-Fi

1. Connect your device to the Guest SSID.

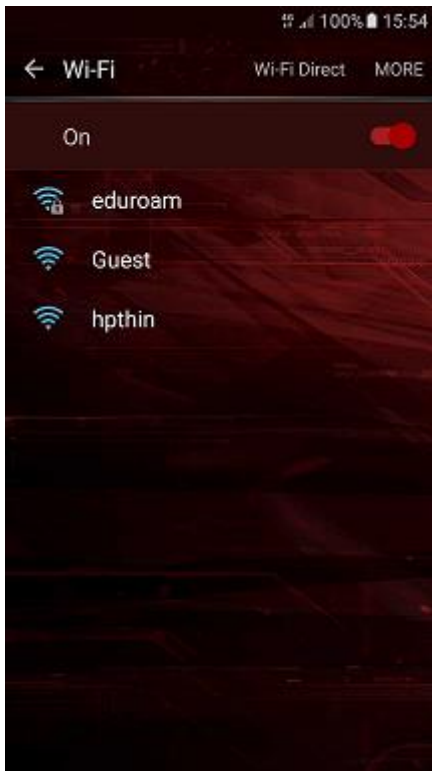

The logon portal will appear. If you already have login details proceed to step B. Otherwise click on **Don't have an account**

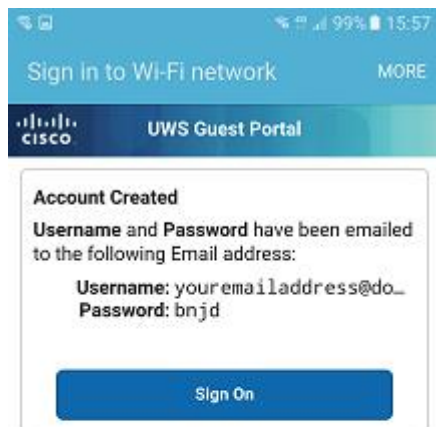
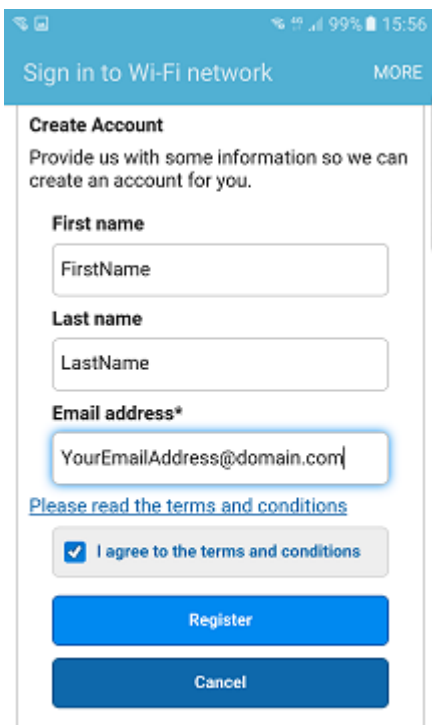

Your username and password will be shown on screen and will also be emailed to you. Take note of your details and click **Sign on** to continue.

You will be asked to enter your details - enter your first name, last name and email address, click **I agree to the term and conditions** then click **Register**.

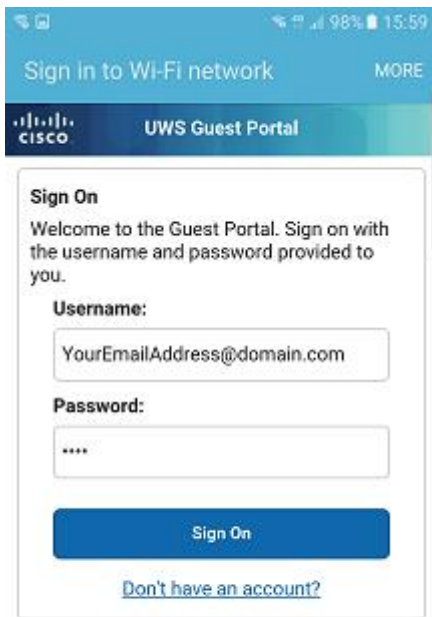

Enter your username and password and click **Sign On**.

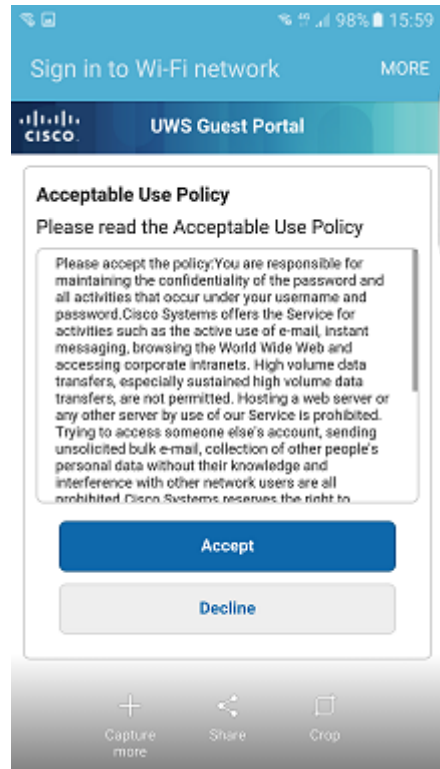

Click **Accept** to accept the Acceptable Use Policy.

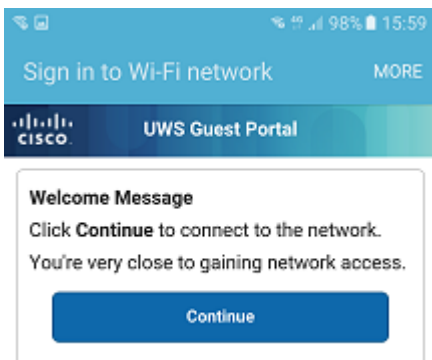

You are now connected to Guest wifi.  
Open your browser to browse the web.

Click **Continue**

## Step B

As you have an account there is no need to register.

Enter your username and password as below. Click Sign On.

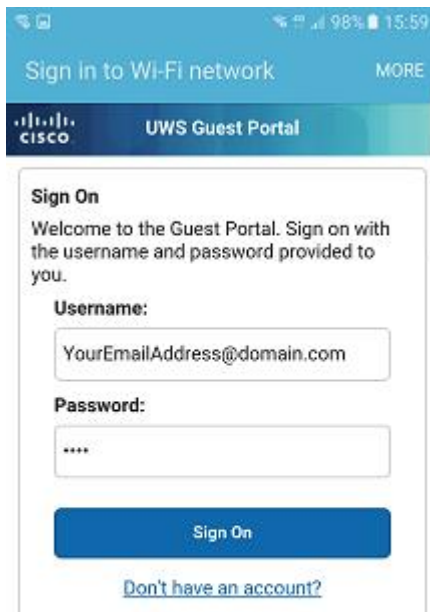

The screenshot shows the 'Sign in to Wi-Fi network' screen for the UWS Guest Portal. The header includes the Cisco logo and the text 'UWS Guest Portal'. Below the header, there is a 'Sign On' section with a welcome message: 'Welcome to the Guest Portal. Sign on with the username and password provided to you.' There are two input fields: 'Username:' with the placeholder text 'YourEmailAddress@domain.com' and 'Password:' with four asterisks. A blue 'Sign On' button is located below the fields, and a link for 'Don't have an account?' is at the bottom.

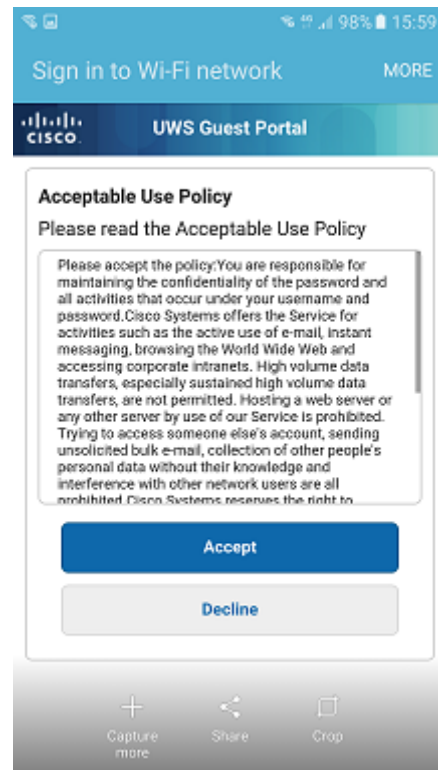

The screenshot shows the 'Acceptable Use Policy' screen for the UWS Guest Portal. The header includes the Cisco logo and the text 'UWS Guest Portal'. Below the header, there is an 'Acceptable Use Policy' section with the text: 'Please read the Acceptable Use Policy'. A scrollable text box contains the policy details: 'Please accept the policy: You are responsible for maintaining the confidentiality of the password and all activities that occur under your username and password. Cisco Systems offers the Service for activities such as the active use of e-mail, instant messaging, browsing the World Wide Web and accessing corporate intranets. High volume data transfers, especially sustained high volume data transfers, are not permitted. Hosting a web server or any other server by use of our Service is prohibited. Trying to access someone else's account, sending unsolicited bulk e-mail, collection of other people's personal data without their knowledge and interference with other network users are all prohibited. Cisco Systems reserves the right to...'. Below the text box are two buttons: a blue 'Accept' button and a grey 'Decline' button. At the bottom of the screen, there are three icons: 'Capture more', 'Share', and 'Crop'.

**Accept** the Acceptable Use Policy.

Click **Continue** to complete the connection

Open your browser and browse to a web page